

"21-inch" Wheel Arch Extension

Concern: **Retrofitting**

Model Year: **As of 2018**

Subject: **ALL** vehicles **except** Cayenne Turbo!
ALL vehicles with 20-inch or smaller wheels!

Restrictions: **NOT** approved for vehicles with SportDesign package (I-no. 2D0)!

Notes: To give the basic models of the Cayenne (9YA) a customized look, a ready-primed "21-inch" wheel arch extension ⇒ *Figure 1* is available as a retrofit option. This comes as standard on the Cayenne Turbo (9YA).

If the wheels on the basic vehicle are to be changed to 21 or 22-inch wheels, this modification is **ONLY** approved together with the "21-inch" wheel arch extension!



Figure 1

Parts Info: **9Y0.044.820**

⇒ "21-inch" wheel arch extension

Parts list:

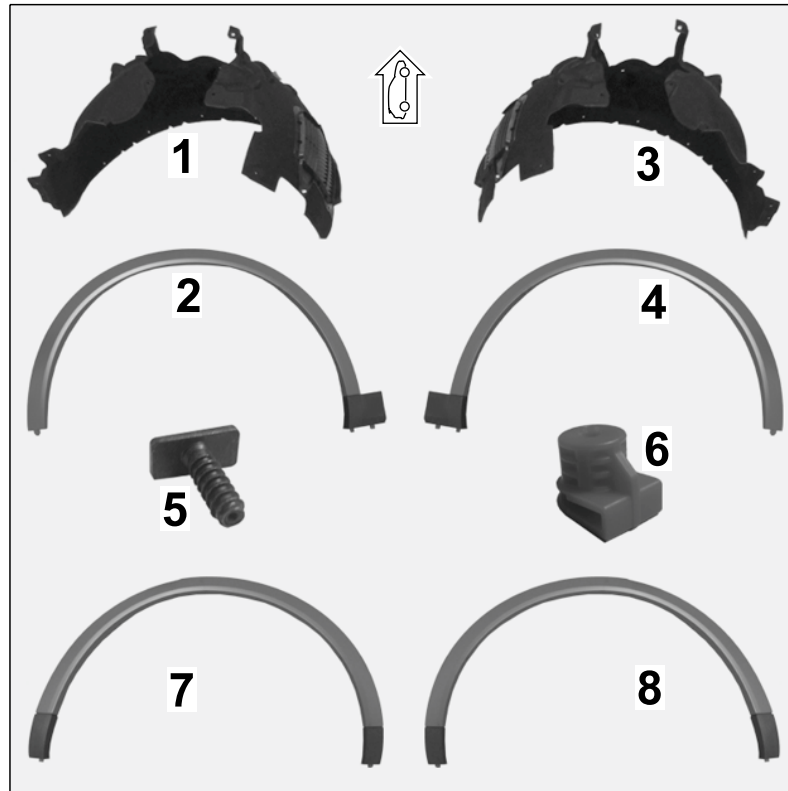

Figure 2

9Y0.810.971.E	1 x	Wheel housing liner, front – left ⇒ Figure 2-1-
9Y0.853.717.K.G2X	1 x	Wheel cover, front – left; ready-primed ⇒ Figure 2-2-
9Y0.810.972.E	1 x	Wheel housing liner, front – right ⇒ Figure 2-3-
9Y0.853.718.K.G2X	1 x	Wheel cover, front – right; ready-primed ⇒ Figure 2-4-
— — —	4 x	T-bolt ⇒ Figure 2-5-
— — —	22 x	Clip ⇒ Figure 2-6-
9Y0.854.731.J.G2X	1 x	Wheel cover, rear – left; ready-primed ⇒ Figure 2-7-
9Y0.854.732.J.G2X	1 x	Wheel cover, rear – right; ready-primed ⇒ Figure 2-8-

Materials:	— — —	— — —	Cleaning cloth (commercially available)
	— — —	— — —	Isopropanol (commercially available)

Tools:	9900 - PIWIS Tester 3	Gap dimension gauge
	Shop light	

Work Procedure: 1 Preparatory work

CAUTION

Painting components

- Risk of warping of components
 - Risk of damage to components
- ⇒ Observe the guidelines and instructions for painting components in the "Paint" Workshop Manual.
- ⇒ Always place parts without tension on the painting devices provided during painting and drying processes.

1.1 Painting wheel cover

1.1.1 Mask trims (black grained ⇒ *Figure 3*) on wheel covers.

- 1 – Trim (black grained – wheel cover, front)
- 2 – Trim (black grained – rear wheel cover – door sill area)
- 3 – Trim (black grained – rear wheel cover – rear apron area)

1.1.2 Paint all ready-primed areas of the wheel cover to match the vehicle's color code in accordance with the "Paint Manual".

1.1.3 Carefully expose trim (black grained ⇒ *Figure 3-1-3-*) from the masking.

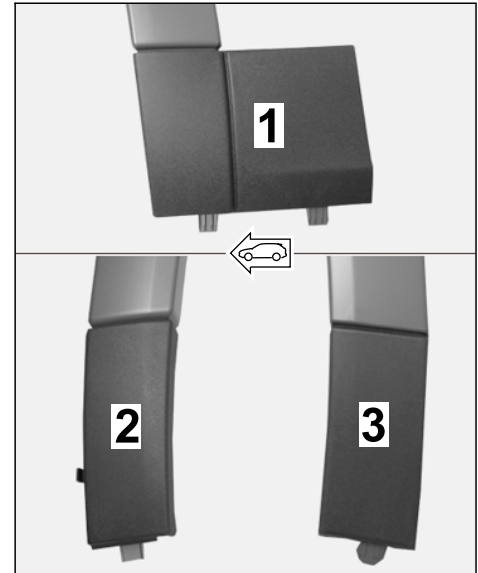

Figure 3

NOTICE

Incorrect procedure

- Risk of damage to paintwork
- ⇒ Do not use tools with sharp edges.
- ⇒ Cover the area you are working on.
- ⇒ Do not use aggressive cleaning agents/solvents.

1.1.4 Fit clip on wheel cover (inside) (⇒ *Figure 4 -A-*).

- 1 – Clip
- 2 – T-bolt
- 3 – Inside of wheel cover

1.1.5 Fit T-bolts on wheel cover (inside) (⇒ *Figure 4 -B-*).

1.2 Drive the vehicle onto a lifting platform and connect battery charger (⇒ *Workshop Manual '2X00IN Battery trickle charging'*).

1.3 Raise the vehicle (⇒ *Workshop Manual '4X00IN Lifting the vehicle'*).

1.4 Remove front wheel housing liner (⇒ *Workshop Manual '505619 Removing and installing front wheel housing liner'*).

1.5 Remove standard front wheel cover (⇒ *Workshop Manual '661919 Removing and installing front wheel cover'*).

1.6 Loosen standard rear wheel housing liner in the wheel housing side panel area (⇒ *Workshop Manual '536919 Removing and installing rear wheel housing liner'*).

1.7 Remove rear wheel housing liner (lower section) (⇒ *Workshop Manual '53691903 Removing and installing rear wheel housing liner (lower section)'*).

2 Installing new painted wheel cover (front axle)

2.1 Guide tabs/pins (at the ends of the wheel cover) into the side skirts and front apron (⇒ *Figure 5*).

- 1 – Pin
- 2 – Tab
- 3 – Side skirts
- 4 – Front apron

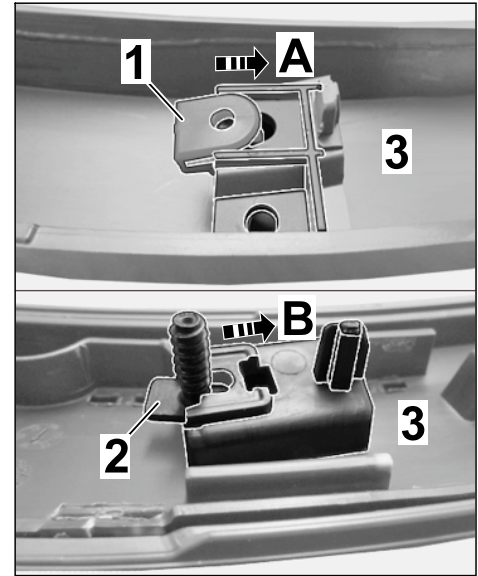

Figure 4

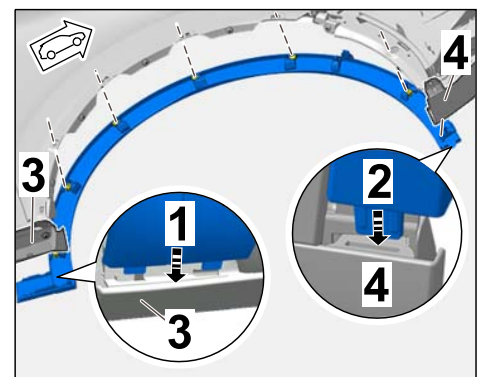

Figure 5

- 2.2 Position pin at the very top clip (at 12 o'clock position) in the fender and screw TP4 x 14 screw (1 x) into the clip on the wheel cover (⇒ *Figure 6 -A-*).

- 1 – Pin
- 2 – Screw, TP4 x 14

Screw, TP4 x 14 (1 x): **Tightening torque 1.5 Nm (1 ftlb.)**

- 2.3 Clip in wheel cover holder in the fender area (⇒ *Figure 6 -B-*).

- 2.4 Clip in wheel cover in the front apron area (2 x ⇒ *Figure 6 -C-*).

- 2.5 Screw TP4 x 14 screws (5 x) into the remaining clips on the wheel cover in accordance with the tightening sequence (⇒ *Figure 6 -D-* and ⇒ *Figure 6 -E-*).

Screw, TP4 x 14 (5 x): **Tightening torque 1.5 Nm (1 ftlb.)**

- 2.6 Install new front wheel housing liner (⇒ *Workshop Manual '505619 Removing and installing front wheel housing liner'*).

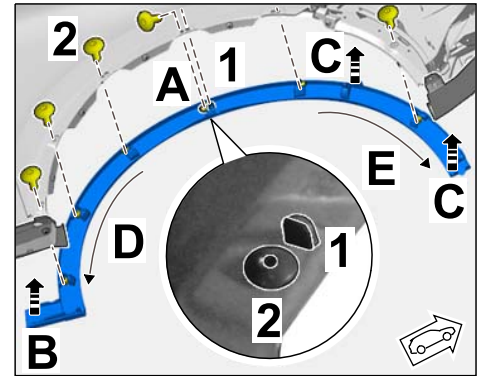

Figure 6

3 Installing new painted wheel cover (rear axle)

- 3.1 Guide tabs (at the ends of the wheel cover) into the rear apron and side skirts (⇒ *Figure 7*).

- 1 – Tab – rear
- 2 – Tab – front
- 3 – Rear apron
- 4 – Side skirts
- 5 – Pin
- 6 – Hexagon nut A5

- 3.2 Position pin and very top T-bolt (at 12 o'clock position) in the side panel and screw A5 hexagon nut (1 x) onto the T-bolt (⇒ *Figure 7 -6-*).

Hexagon nut, A5 (1 x): **Tightening torque 1.5 Nm (1 ftlb.)**

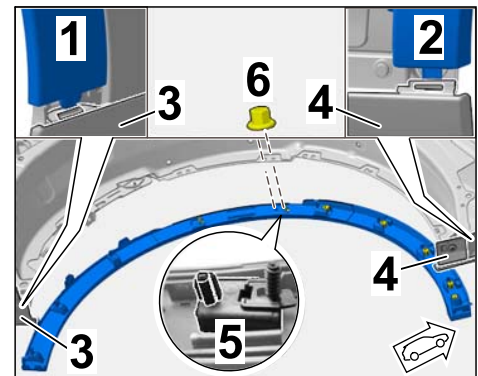

Figure 7

- 3.3 Clip wheel cover into brackets on rear apron (3 x ⇒ *Figure 8-A-*).

- 1 – Rear apron
2 – Side skirts
3 – Clip

- 3.4 Screw TP4 x 14 screws (5 x) into the remaining clips on the wheel cover in accordance with the tightening sequence (⇒ *Figure 8-B-*).

Screw, TP4 x 14 (5 x): **Tightening torque 1.5 Nm (1 ftlb.)**

- 3.5 Screw A5 hexagon nut (1 x) onto the second T-bolt (⇒ *Figure 8-C-*).

Hexagon nut, A5 (1 x): **Tightening torque 1.5 Nm (1 ftlb.)**

- 3.6 Install rear wheel housing liner (lower section) (⇒ *Workshop Manual '53691903 Removing and installing rear wheel housing liner (lower section)*).

- 3.7 Secure standard rear wheel housing liner in the wheel housing side panel area (⇒ *Workshop Manual '536919 Removing and installing rear wheel housing liner*).

4 Concluding work

- 4.1 Lower the vehicle (⇒ *Workshop Manual '4X00IN Lifting the vehicle*).
- 4.2 **9900 - PIWIS Tester 3** must be connected to the vehicle and then switched on.
- 4.3 Read out the fault memory of all systems, work through any existing faults, and erase the fault memory (⇒ *Workshop Manual '033500 Fault memory for on-board diagnosis*).
- 4.4 Disconnect battery charger (⇒ *Workshop Manual '2X00IN Battery trickle charging*) and drive the vehicle off the lifting platform.

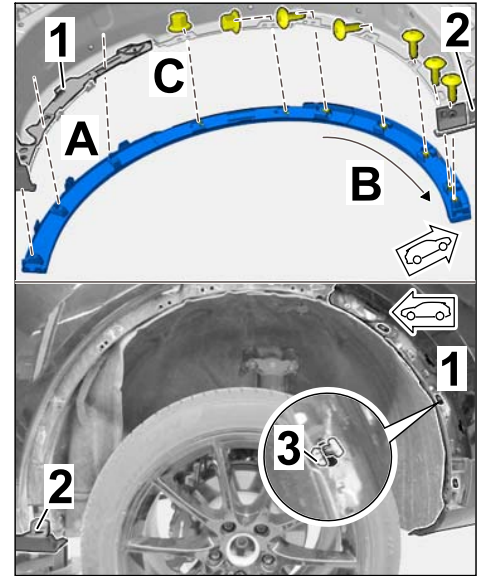

Figure 8

- 66 99 61 71: –Wheel cover (4 ea.), new part painted–
Includes: Materials: 12 MU
Without: Paint preparation (separate LO No.)! Labor time: **160 TU**
- 51 01 71 05: –Body paintwork prepared
Includes: Order-based;
New part painting Step 1;
Plastic part Labor time: **130 TU**
- 66 99 55 40: –Wheel cover (4 ea.) removed and installed–
Includes: Removing front wheel housing liner.
Installing new front wheel housing liner.
Loosening and securing rear wheel housing liner, front/rear
wheel cover (left/right) replaced. Labor time: **264 TU**

Important Notice: Technical Bulletins issued by Porsche Cars North America, Inc. are intended only for use by professional automotive technicians who have attended Porsche service training courses. They are written to inform those technicians of conditions that may occur on some Porsche vehicles, or to provide information that could assist in the proper servicing of a vehicle. Porsche special tools may be necessary in order to perform certain operations identified in these bulletins. Use of tools and procedures other than those Porsche recommends in these bulletins may be detrimental to the safe operation of your vehicle, and may endanger the people working on it. Properly trained Porsche technicians have the equipment, tools, safety instructions, and know-how to do the job properly and safely. Part numbers listed in these bulletins are for reference only. The work procedures updated electronically in the Porsche PIWIS diagnostic and testing device take precedence and, in the event of a discrepancy, the work procedures in the PIWIS Tester are the ones that must be followed.

© 2018 Porsche Cars North America, Inc.